



Level Switches

In fuel oil applications fuel is typically stored in day tanks, the control of the level in these tanks are handled by level switches. Typically the level probe will have several level switches mounted on a single rod. Typical switches are used for:

- Turning on and off a supply pump to refill a tank
- Closing the supply valve when a tank has reached the “full” level
- High level alarm
- Turn on a return pump to protect the tank from overfilling
- Low level alarm that may also turn on a backup pump
- A very low alarm that is usually used to turn off the generator to protect the generator
- As an option a temperature sensor can be built into the sensor to protect the generator from overly hot fuel oil

In some short tanks such as base tanks located under the generator these level switches may not fit on one rod, therefore multiple probes are used.

Specifications:

- 2" NPT tank fitting, but others are available
- Brass Stem
- 316SS Floats
- 240V DC/AC Switch contact rating
- Cast Aluminium J-Box with terminal strip
- Individual pair of contacts for each switch

High Level Switches

For large main tank which typically have continuous level monitoring (displayed in gallons), a simple level switch is typically used as a back up to stop filling of the main tank. These switches are typically set at between 90 and 95% of full. So on a 12 foot diameter tank these single level switch probes will go into the tank only 12 to 18 inches.



Level Switches



High Level Switches

Dry Pump Protection Switch

A level switch can be mounted in a pipe well before a pump to act as an interlock to protect the pump from running dry. With no oil in the pipe before the pump the float will open the circuit and the pump will not be allowed to run.

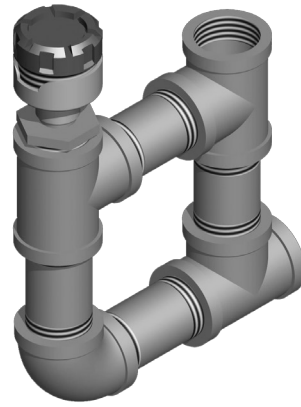

Overflow Level Switches

Level switches can also be fitted into the vent of a tank, if the oil was to raise to a level where it overflows into the vent the level sensor will sense oil and act as an interlock to protect from the oil from overflowing and possible going out the vents.



Subject to Change without notice

V.6 13014.DS

Our Fuel Oil Pump Set products are only a part of our complete family of equipment that makes up a typical fuel oil system. Please contact us for your complete system needs.



One Lincoln Centre, 18W140 Butterfield Road, Suite 1100, Oakbrook Terrace, IL 60181, Office: 630-756-4382

iFuelsys.com